



Oilless Diaphragm Pump to 4.3 lpm



DC Model



AC Model

Miniature Diaphragm 10D1125 Series

AC MOTOR

15 PSI MAX. PRESSURE, 15" HG MAX. VACUUM
3.8 LPM OPEN FLOW

DC MOTOR

15 PSI MAX. PRESSURE, 14" HG MAX. VACUUM
4.3 LPM OPEN FLOW

Product Specifications

Model Number	Motor	Max. Amp. Draw	Material	Net Wt. lbs. kg	
10D1125-101-1051	6V DC	1	EPDM	.5	0,23
10D1125-101-1052	12V DC	.5	EPDM	.5	0,23
10D1125-101-1053	24V DC	.3	EPDM	.5	0,23
10D1125-101-1068	12V BLDC	.5	EPDM	.5	0,23
10D1125-101-1070	24V BLDC	.3	EPDM	.5	0,23
10D1110-101-1043	115-60-1	.6	EPDM	1.85	0,83

PRODUCT FEATURES

- Use as compressor or vacuum pump (same model)
- Mount in any plane
- Maintenance-free ball bearings are sized for long life
- Diaphragm and valve are easily field serviceable, if required
- Alternate stroke options available
- Custom mounting configurations available
- Heads mount in any of four positions
- Heads available with threaded or barbed ports
- Motor equipped with Electro-Magnetic Interference suppression

MATERIALS OF CONSTRUCTION

- Head assembly of chemical- and heat-resistant PPS for corrosion resistance
- EPDM (Ethylene Propylene Diene Monomer) valve and diaphragm

Product Performance (Metric, U.S.)

Note: DC performance data taken at nominal voltage.

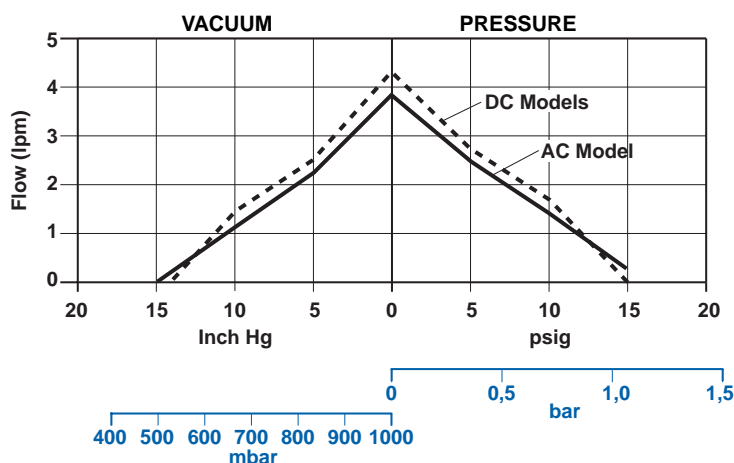

inches/mm
AC MODEL

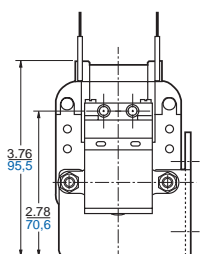
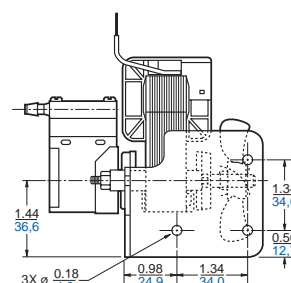
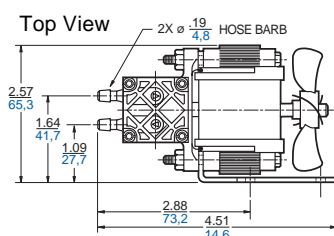

Note: Use #6 Plastite Thread Forming Screw

inches/mm

DC MODELS

